

SITUATIA EXISTENTA - sc. 1:200

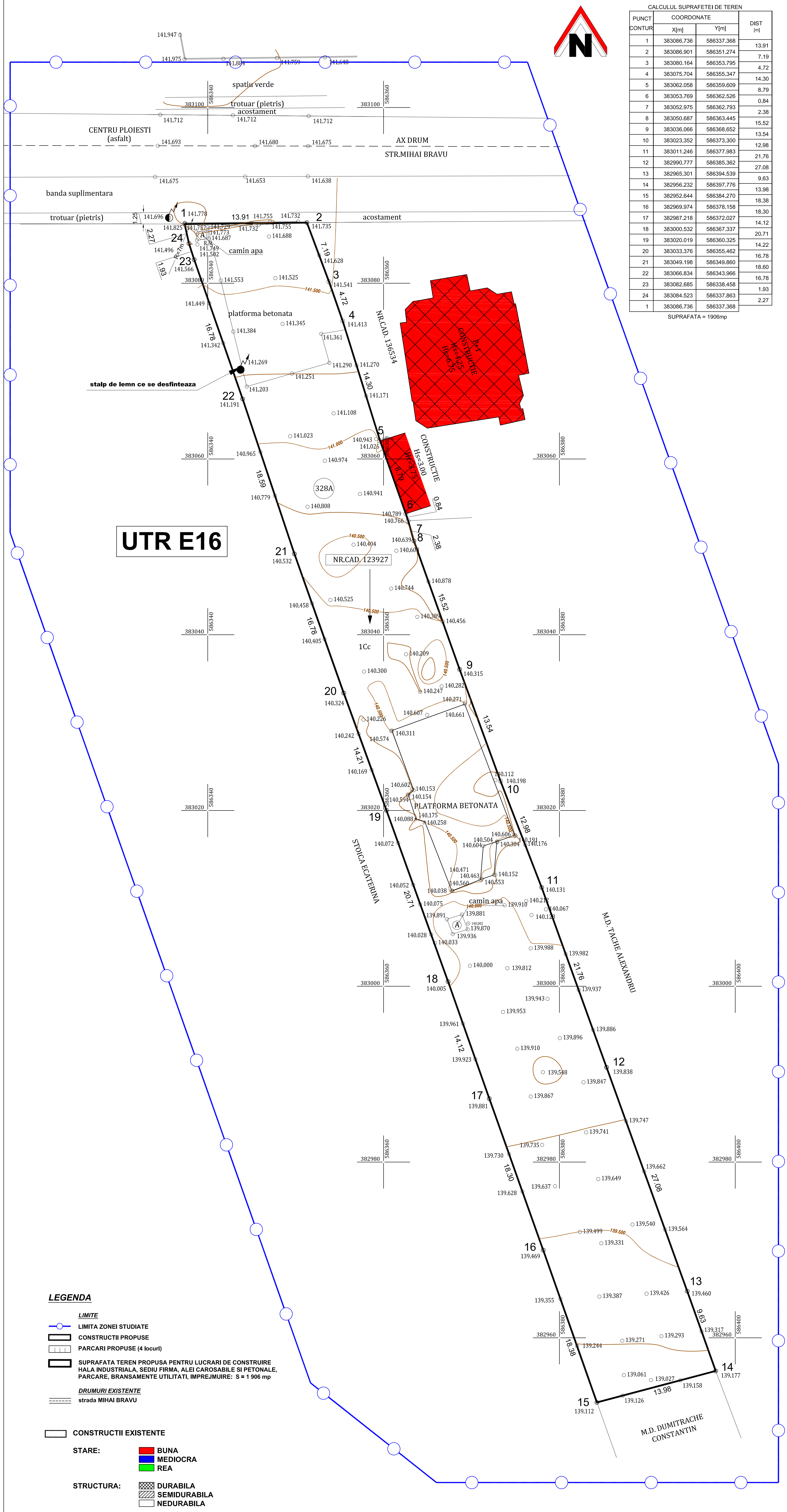

CALCULUL SUPRAFETEI DE TEREN			
PUNCT CONTUR	COORDONATE		DIST [m]
	X[m]	Y[m]	
1	383086.736	586337.368	13.91
2	383086.901	586351.274	
3	383080.164	586353.795	7.19
4	383075.704	586355.347	4.72
5	383062.058	586359.609	14.30
6	383053.769	586362.526	8.79
7	383052.975	586362.793	0.84
8	383050.687	586363.445	2.38
9	383036.066	586368.652	15.52
10	383023.352	586373.300	13.54
11	383011.246	586377.983	12.98
12	382990.777	586385.362	21.76
13	382965.301	586394.539	27.08
14	382956.232	586397.777	9.63
15	382952.644	586384.270	13.98
16	382969.974	586378.158	18.38
17	382987.218	586372.027	18.30
18	383000.532	586367.337	14.12
19	383020.019	586380.325	20.71
20	383033.376	586355.462	14.22
21	383049.198	586349.860	16.78
22	383066.834	586343.966	18.60
23	383082.685	586338.458	16.78
24	383084.523	586337.863	1.93
1	383086.736	586337.368	2.27

SUPRAFATA = 1906mp

BIROU INDIVIDUAL DE ARHITECTURA Arh. Anca Poli str. Constantin Brzeanu nr. 9, bloc 202C, ap. 153, Ploiesti			Beneficiar: S.C. VISTEON PROJECT S.R.L. Amplasament: PLOIESTI, str. MIHAI BRAVU nr. 328A , JUD. PRAHOVA		
Proiect 43/2016		FAZA P.U.D.	Data: 10.2016	Denumire proiect: P.U.D. CONSTRUIRE HALA INDUSTRIALA, SEDIU FIRMA, ALEI CAROSABILE SI PIETONALE, PARCARE SITUATIA EXISTENTA	
Sef proiect: Arh. Anca Poli		Sc: 1/200			
Proiectat: Arh. Anca Poli		Plansa: A 3			
Desenat: Arh. Anca Poli					